



## V21 PRODUCT SETUP AND LOADING INSTRUCTIONS

FOLLOW THE 3 STEPS BELOW WHEN SETTING VENDOR UP FOR A PRODUCT

1

**BACK SPACER**  
Adjust the back spacer to provide approx. 1/4" to 1/2" gap between the front spacer, product and back spacer.

1/4" TO 1/2" GAP  
FRONT SPACER/RETAINER  
BACK SPACER  
FRONT REAR

---

2

**PRODUCT STEP**  
For short product vending, move the product step to the "FORWARD" position.  
For tall product vending, move the product step to the "BACK" position.

"FORWARD" FOR SHORT PRODUCT  
"BACK" FOR TALL PRODUCT

SHORT PRODUCT = LESS THAN 7.0" TALL (PRODUCT STEP FORWARD)  
TALL PRODUCT = MORE THAN 7.0" TALL (PRODUCT STEP BACK)

---

3

**DEPTH SETTING (ELECTRONIC CONTROL MODE)**  
The "DEPTH SETTING" for each column must correspond to the number of products in the column. For example; the depth setting for a column vending double depth bottles must be set to "2", and a column set to vend quadruple depth cans must be set to "4". Refer to the VEC 12 programming instructions for details on how to access and change the depth setting mode.

- 4 Deep: Cans between 4.50" and 4.85" tall.
- 3 Deep: Bottles or cans between 4.85" and 6.50" tall.
- 2 Deep: Bottles between 6.50" and 9.95" tall.
- 1 Deep: Bottles taller than 9.95".

MIN. PRODUCT HEIGHT  
4D 3D 2D 1D

PRODUCT LOADING

- Single depth bottles should be loaded with cap toward the back.
- Double depth bottles may be loaded with caps toward the back, or butt to butt.
- Triple depth bottles must be loaded with caps toward the back.
- Quadruple depth cans may be loaded any direction.

FRONT VENDOR REAR

1D  
2D  
2D  
3D  
4D

---

SMALL DIAMETER PRODUCT SETTING

- Small diameter products (less than 2.5" Ø) such as 500 ML water bottles require the use of side spacer, PN: 1125921
- Small diameter 250 ML energy drink cans (2.1" Ø) require the use of conversion kit PN 1121638.

2.5" Ø OR LESS  
2.1" Ø

---

NOTES

- Side spacers **ARE NOT** required for 12 oz. can vending.
- Vend mechanism is self priming. No need to manually prime after initial load or reload.
- For questions regarding product settings, contact the Vendo Technical Services Department at 1-800-344-7216 ext.3368 (US/Canada) or 559-439-1770 ext.3368.

1124026

FIGURE 6

G-7

## V21 Side Spacer Installation Instructions

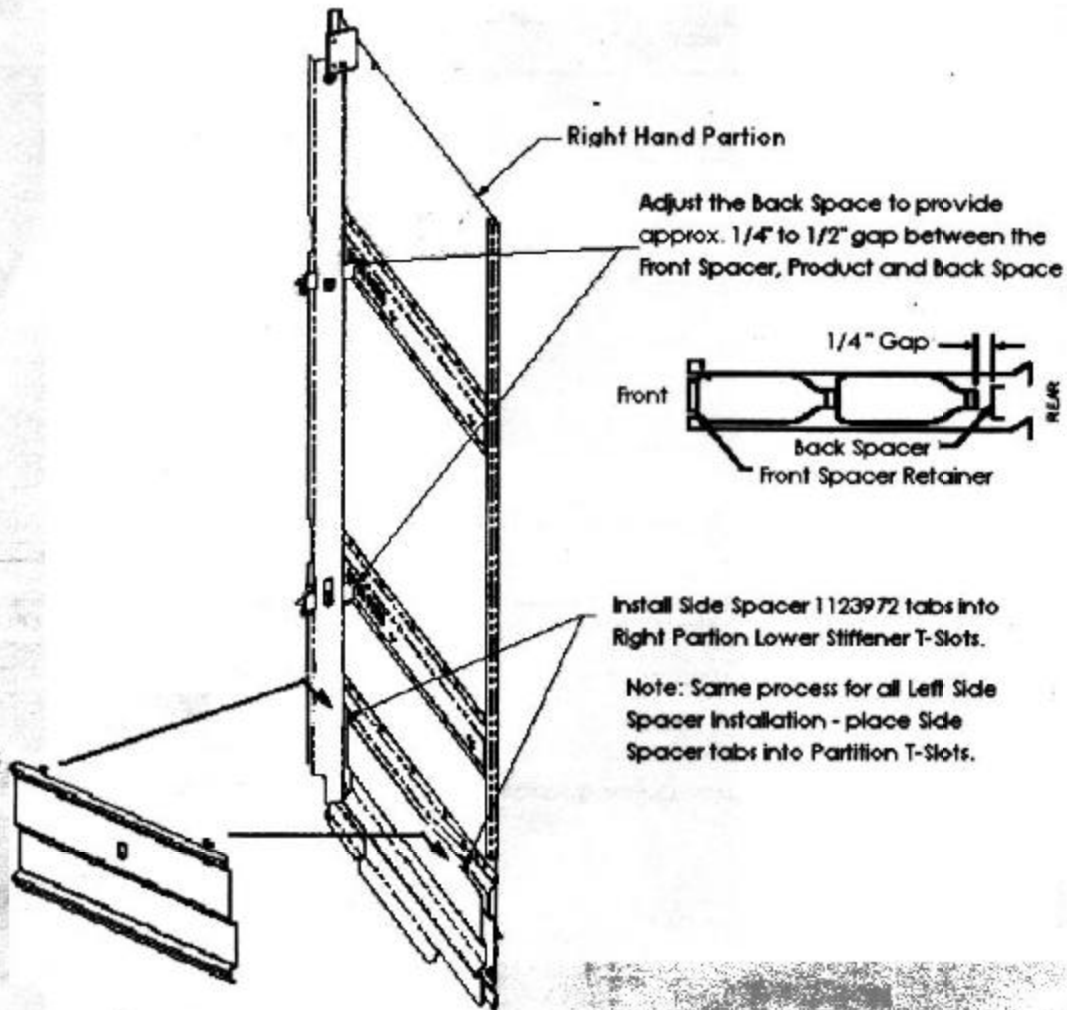

### V21 STACK SETTING FOR 8.4oz CAN, RED BULL

- 1 DEPTH: 3
- 2 BACK SPACER: 7
- 3 PRODUCT STEP/SLIDER: FORWARD
- 4 SPACERS & LOCATION: 1125972 (Middle Left Side Partion),  
1123123 (Top & Bottom Left Side Partion) & 1123972 (Bottom Right Side Partion).

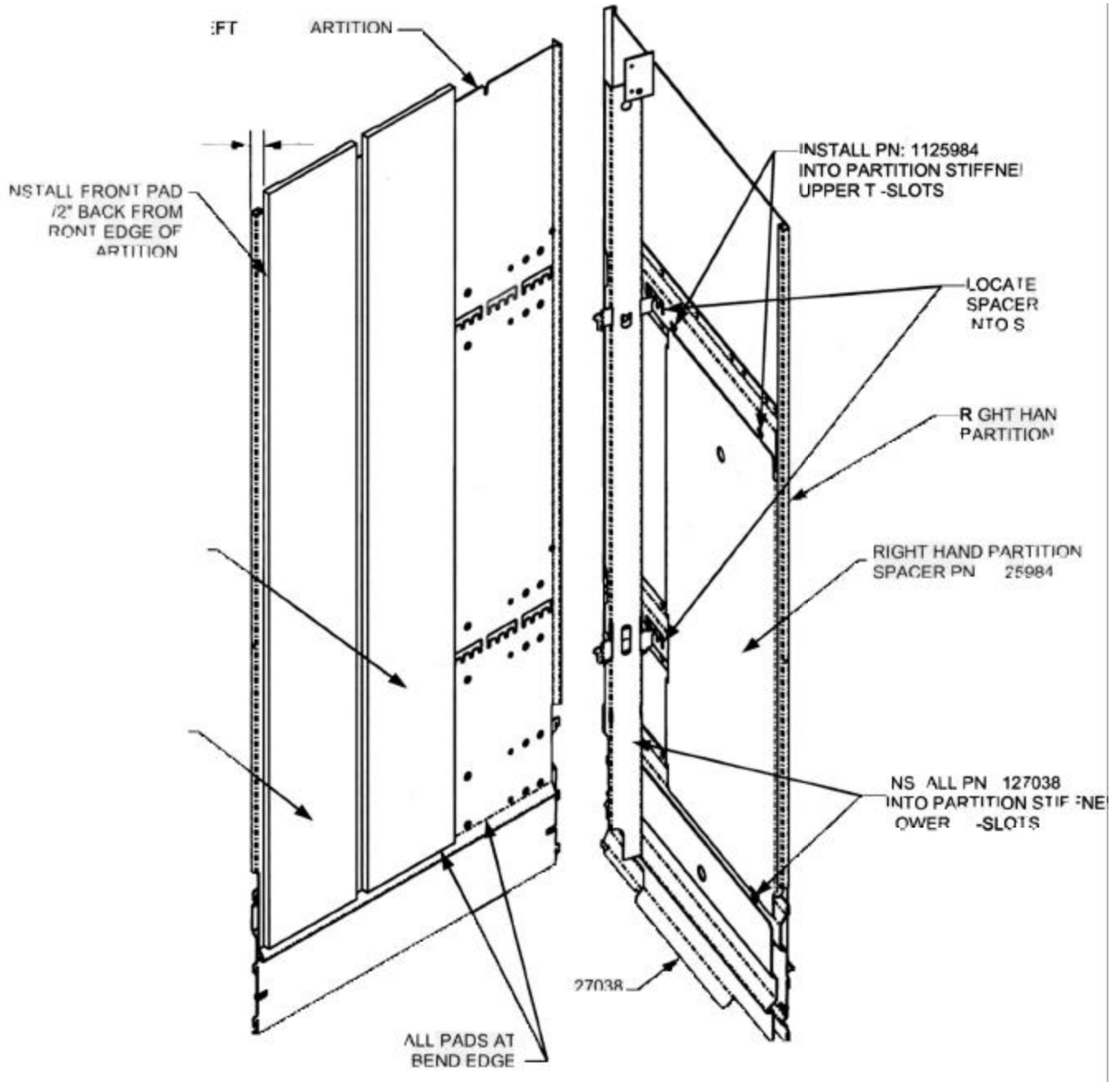

STANDARD. CAPS FACE TOWARDS BACK

Fig

## V21 SETUP GUIDE-VARIOUS PRODUCTS

ASSEMBLY#	VARIOUS PRODUCTS	DEPTH SET	BS POSITION	CLIP LOC	SIDE SPACERS	BS locations -- ->	
1126095	12 OZ CANS	4	12	BACK	NO		F 1 2 3 4 5 6 7 8 9 10 11 12 Back
-1	20 OZ COKE	2	10	FWD	NO		
-2	8.4 ENERGY DRINKS	3	6	BACK	1125972,1123123 ( * ) 1123972	* TWO	
-3	20 OZ DASANI	2	9	BACK	NO		
-4	20 OZ POWERADE	2	5	BACK	NO		
-5	15.2 DOLE	2	5	BACK	NO		
-6	16 OZ NO FEAR	2	1	FWD	NO		
-7	20 OZ GENERIC	2	9	BACK	NO		
-8	8.4 RED BULL	3	7	FWD	1125972,1123123 ( * ) 1123972	* TWO	
-9	16 OZ FRUIT 2o	2	5	BACK	NO		
-10	16.9 SNAP 2 O	2	5	BACK	1125921		
-11	16.9 OZARKA WATER	2	8	BACK	1125921		
-12	16.9 AROWHEAD	2	5	BACK	1125921		
-13	20 OZ SNAPPLE	2	5	BACK	NO		
-14	20 OZ NOAH WATER	2	6	BACK	NO		
-15	20 OZ DP ATLANTA	2	9	BACK	NO		
-16	20 OZ DP ABILIENE	2	9	BACK	1125983 1125984		
-17	16.9 500ML GENERIC	2	9	BACK	NO		
-18	500ML HI LAND SPRNG	2	7	BACK	NO		
-19	20 OZ ARROWHEAD	2	6	BACK	NO		
-20	375 ML CAN AUSTRLA	3	5	FWD	NO		
-21	24 OZ OZARKA SPORT	2	12	BACK	NO		
-22	24 OZ ABERFOYLE SPRT	2	12	BACK	NO		
-23	16.9 ICE MOUNTAIN	2	7	BACK	1125921		
-24	16.9 ZEPHERHILLS	2	7	BACK	1125921		
-25	16.9 DEERPARK	2	7	BACK	1125921		
-26	16.9 POLAND SPRINGS	2	7	BACK	1125921		
-27	20 oz OZARKA	2	6	BACK	NO		
-28	20 OZ DEER PARK	2	6	BACK	NO		
-29	20 OZ POLAND SPRINGS	2	6	BACK	NO		
-30	8 oz Mickey Mouse	2	1	BACK	1125984 foam spcr, 1114348-12, 1121822-7, 1127002		
-31	8 oz Arrowhead	3	3	BACK	1121822-4, 1127038, 1125484		
-32	20 oz DP	2	9	BACK	neck guides kit 1126163		
					prod ret clips 1125200 1125201		
-33	20 oz Zephrillis	2	6	BACK	no		
-34	6.6 Starbucks dble shot	3	1	FWD	1125972-1, 1123123-1(*) 1123972-1	TWO	
-35	20 Dp Taper neck 821	2	9	BACK	mag spcr (2) 1121822-7 for 821, neckguides 1128023	special stack	
-35	20 oz taper neck 721	2	9	BACK	neck guide kit 1127775, 1127776	special stack	
-36	330 ML CANS	4	9	FWD	NONE		
-37	16.9 Nestle pure water	2	7	fwd	1125921		

## 20 oz Vault Bottle

### Setup Instructions for Vendo Vending Machines



Vender Models	Column Type	Loading Info.	Parts Needed for <u>Each</u> Column				Steps to complete for <u>Each</u> Column	
			?	#	Part Description	Part Number	?	
<b>V-Max</b> V-840 V-800 V-630 V-603 V-540 V-720	Narrow	Caps to Rear  Double Depth		1 1 1	Gage Bar Clip A Short Sold Out Flap Sold Out Spacer	1066112 1083449 1077457		1. Install gage bar clip A: <b>Position # 1</b> 2. Gage bar location: <b>1</b> 3. Adjust rear spacer: <b>hole # 17</b>
<b>V-21</b>	Narrow	Caps to Rear  Double Depth						1. Adjust rear spacer: <b>10</b> 2. Lower partition clip: <b>Back</b>
<b>Uni II</b>	Narrow	Caps to Rear  Single Depth		1 1 1	Gage Bar Clip A Short Sold Out Flap Sold Out Spacer	1066112 1083449 1077457		1. Install gage bar clip A: <b>Position # 1</b> 2. Gage bar location: <b>1</b> 3. Adjust rear spacer: <b>C</b>
<b>GFV</b>	Shelves	Package Upright			N/A	N/A		N/A

**NOTES:**

- For technical assistance, contact The Vendo Company at 1-800-344-7216 or [www.vendoco.com](http://www.vendoco.com).