

## AP 120 RETROFIT SENSOR KIT INSTALLATION INSTRUCTIONS

### 1. Kit Components

The AP120 Sensor kit contains a Primary Sensor board and a Secondary Sensor board, both mounted on brackets. The two boards are connected by a 60" Sensor cable. Another longer cable, the Sensor to VMC, is attached to the Primary board.

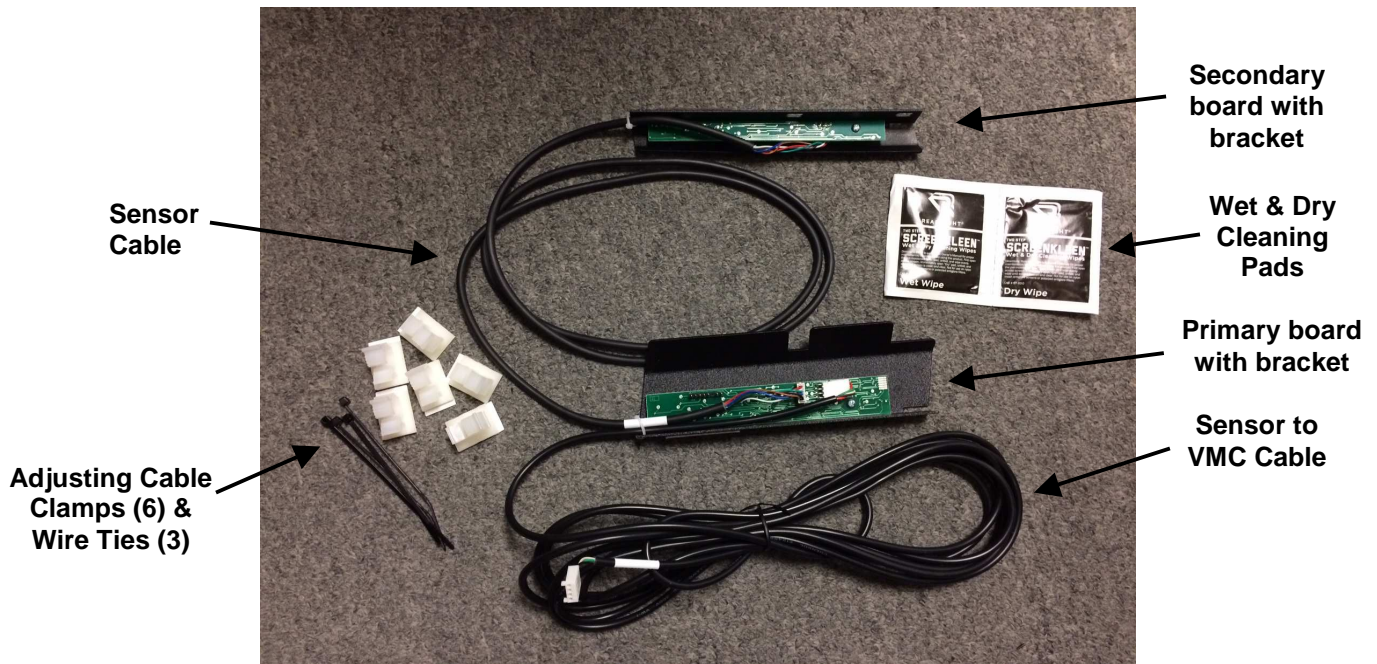

### 2. Primary and Secondary Sensor Boards & Brackets

The Primary and Secondary Sensor Boards & Brackets are attached to the drop bucket in the same way. The Primary is attached to the door hinge side of the drop bucket. The Secondary is attached to the door latch side of the drop bucket.

**Before installing, clean the vertical edge on each side of the vend bucket to remove any dirt or grime.**

Unscrew the 2 drop bucket support mounting screws on each side (top of drop bucket near the display window).

Remove the red tape protector on the underside of Primary bracket. Keeping the tape end of the bracket up slightly, slide the bracket under the support piece near the window. Push all the way up, pull back about 1/4", and make sure the screw can be reinstalled. Push down on the tape end making sure the bracket is lined up with the vend bucket edge. Apply pressure to enhance the adhesive bonding. Insert the screw and tighten.

Repeat the above procedure for the Secondary side.

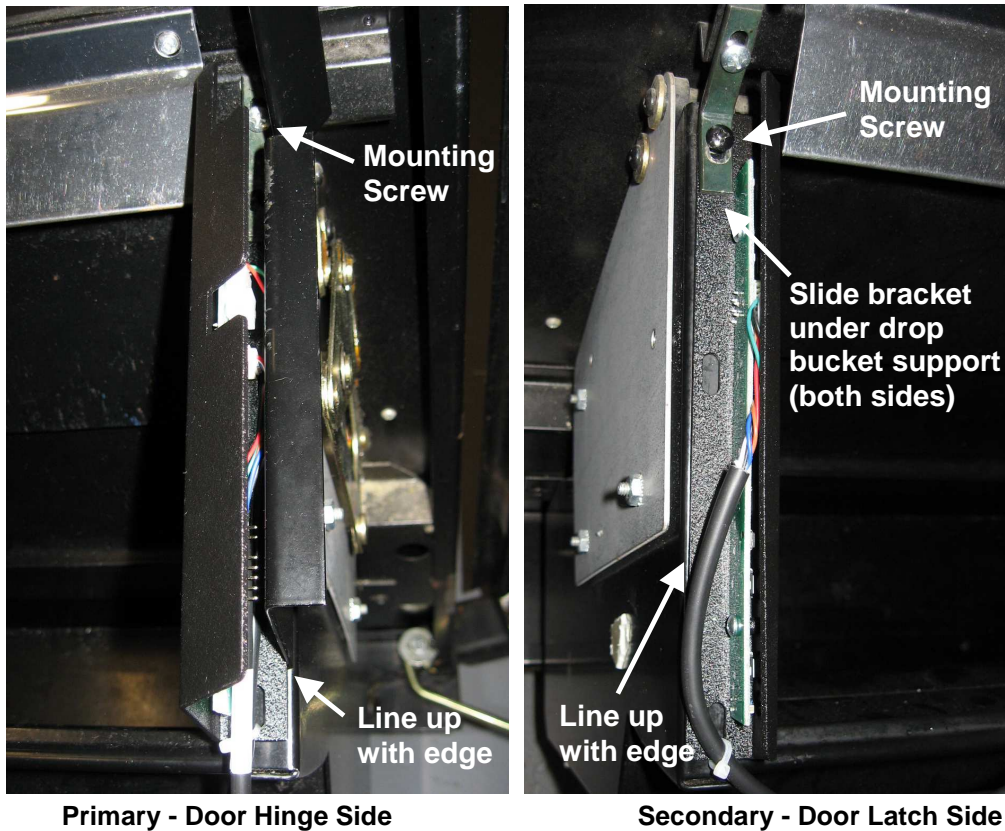

### 3. Sensor and VMC Cable Connections

The cable that connects the Primary and Secondary sensors is dressed down the edge of the drop bucket and across the bottom or rear (installer preference). The Sensor to VMC cable plugs into the controller's **J24** Drop Sensor connector. Cable clamps should be used to hold all cables.

**>>> Clean the area where the clamps go so it is free of any dirt or grime <<<**

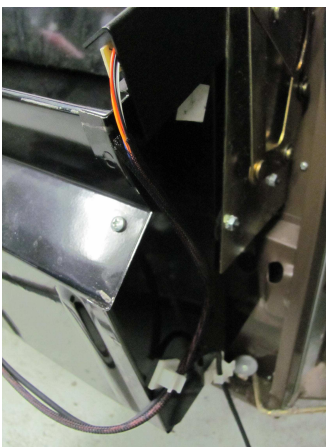

Cables dress down side of drop bucket on each side.

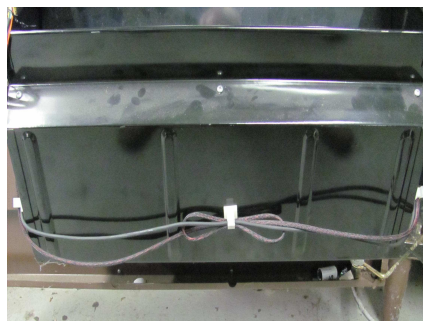

Remainder of the cable should run along the outside of the bucket. The cable can either be mounted across the rear as shown or below the bucket.

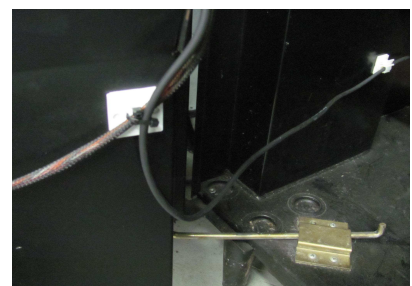

The picture shows the recommended cable dress near the door hinge. Adjustable cable clamps are provided for routing the cable across the bottom of the cabinet. Insure the cable clamp shown is toward the rear of the vertical frame so the vend bin will close properly without hitting it.

**It's important to keep all cables tied to the bracket to keep them from snagging in the machine when the door is closed. Once the sensor kit is completely installed, close the door slowly to ensure that the cables clear all internal frame metalwork.**